

A66 Northern Trans-Pennine Project

Scheme 08: Cross Lanes to Rokeby

TR010062

5.13 Land Plans

APFP Regulations 5(2)(i)

Planning Act 2008

**Infrastructure Planning (Applications: Prescribed Forms and
Procedure) Regulations 2009**

June 2022

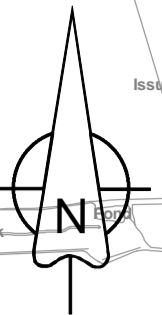
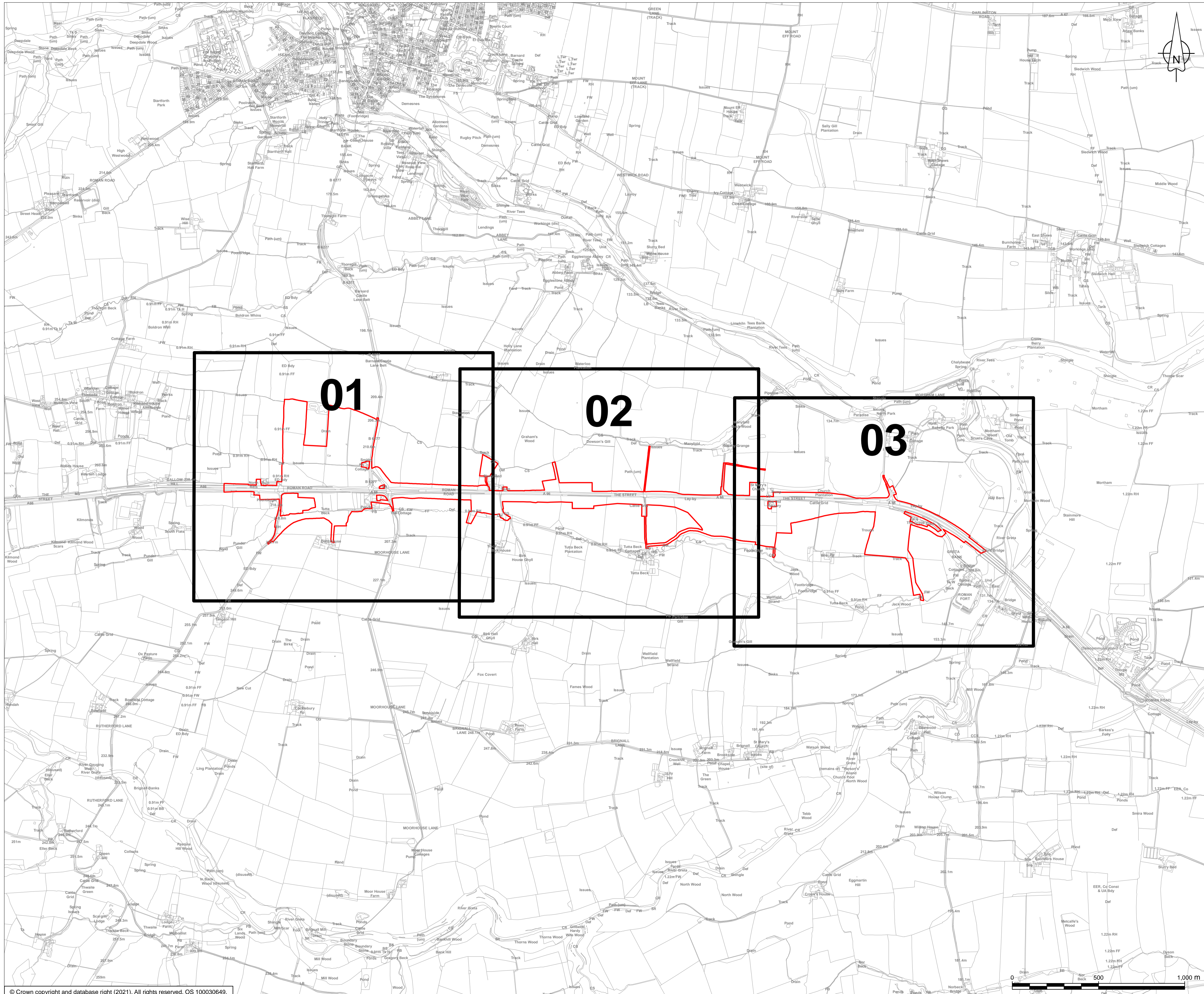

- NOTES**
1. ALL DIMENSIONS ARE IN METRES UNLESS STATED OTHERWISE.
 2. THESE LAND PLANS SHOULD BE READ IN CONJUNCTION WITH OTHER PLANS AND DOCUMENTS IN THE DEVELOPMENT CONSENT.
 3. ALL EASEMENTS, SERVITUDES AND PRIVATE RIGHTS IN LAND ARE PROPOSED TO BE EXTINGUISHED ON LAND SHOWN COLOURED PINK ON THESE LAND PLANS. ALL EASEMENTS, SERVITUDES AND PRIVATE RIGHTS IN LAND ARE PROPOSED TO BE EXTINGUISHED, SO FAR AS THEIR CONTINUED EXERCISE WOULD BE INCONSISTENT WITH THE EXERCISE OF THE RIGHTS OR RESTRICTIONS PROPOSED TO BE ACQUIRED BY THE UNDERTAKER ON LAND SHOWN COLOURED BLUE ON THESE LAND PLANS. ALL EASEMENTS, SERVITUDES AND PRIVATE RIGHTS ARE PROPOSED TO BE SUSPENDED WHILE THE UNDERTAKER IS IN TEMPORARY POSSESSION OF THE LAND SHOWN COLOURED GREEN ON THESE LAND PLANS.
 4. THE NUMBER LABELS RELATE TO PLOT NUMBERS. PLEASE REFER TO THE BOOK OF REFERENCE FOR MORE INFORMATION ABOUT THESE PLOTS, INCLUDING THE APPROXIMATE AREA OF EACH PLOT (IN SQUARE METRES). PLOT NUMBERS INCLUDE A REFERENCE TO THE RELEVANT SHEET OF THE LAND PLANS. IN THIS NUMBERING CONVENTION, A PLOT NUMBER COMPRISES THE SCHEME NUMBER, FOLLOWED BY THE SHEET NUMBER (OF THE SET OF LAND PLANS RELATING TO THAT NUMBERED SCHEME), FOLLOWED BY THE ACTUAL PLOT NUMBER ON THAT SHEET, E.G. PLOT 03-01-24, WHERE 03 IS THE SCHEME NUMBER (SCHEME 03), 01 IS THE SHEET NUMBER (SHEET 01 OF THE LAND PLANS FOR SCHEME 03) AND 24 IS THE PLOT NUMBER (PLOT 24 ON SHEET 01).

- KEY**
- ORDER LIMITS
 - SHEET USED AS PART OF THE DRAWING SERIES

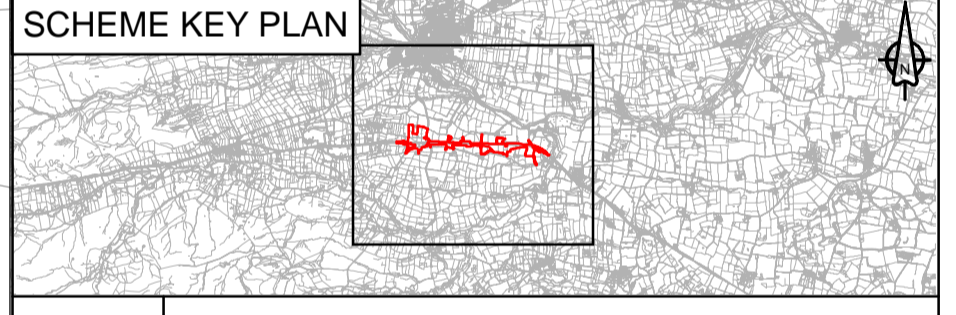
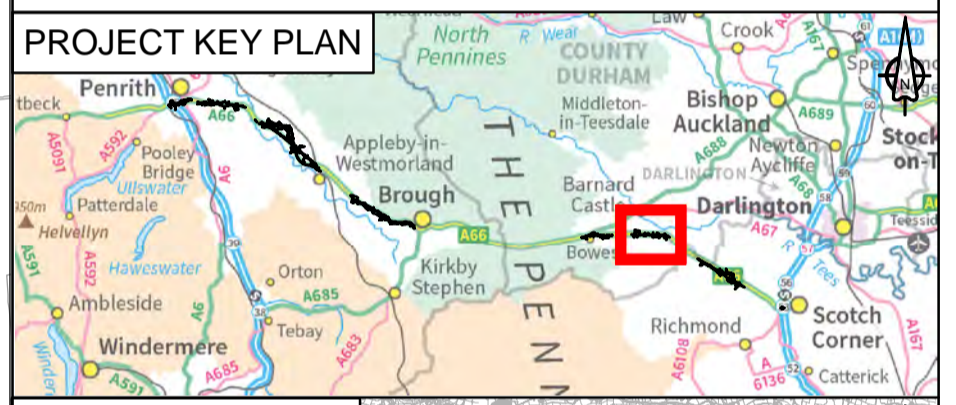

| | | | | | |
|----------|----------|----------|----------|----------|------------|
| C01 | JHILL | JHILL | NWHIT | GEAC | PCAR |
| | 06/06/22 | 06/06/22 | 07/06/22 | 07/06/22 | 08/06/22 |
| Revision | Created | Checked | Reviewed | Approved | Authorised |
| | dd/mm/yy | dd/mm/yy | dd/mm/yy | dd/mm/yy | dd/mm/yy |

Purpose
DCO APPLICATION

PINS Reference Number
TR010062/APP/5.13

Client
**3 Piccadilly Place
Manchester
M1 3BN**

Project Name / Scheme Name
**A66 Northern Trans-Pennine Project
Scheme 08
Cross Lanes to Rokeby**

Drawing Title
**Land Plans
Regulation 5(2)(i)
Key Plan**

| | | | | |
|------------------|-------|-------------|----------|------|
| Project Ref. No. | Stage | Scale : | 1:10,000 | @ A1 |
| --- | PCF3 | Dimension : | M | |

Drawing Number
**HE565627 - AMY - HAC -
S08 - DR - YL - 00001**

Location | Type | Role | Number

| | | |
|-------------|-----------------------------|----------|
| Suitability | Suitability Description | Revision |
| A | Approved for Stage Complete | C01 |

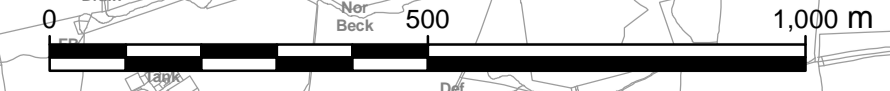

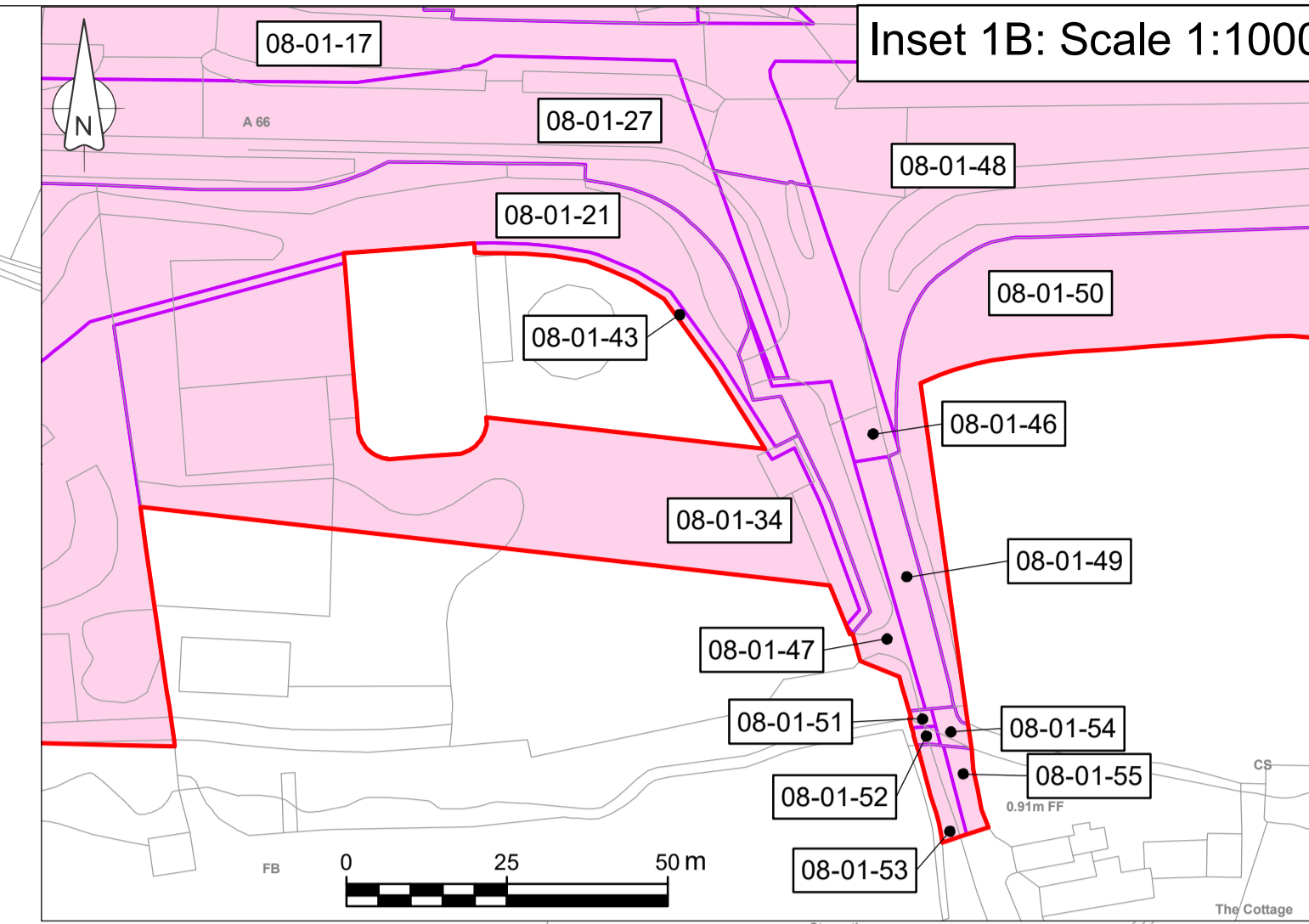
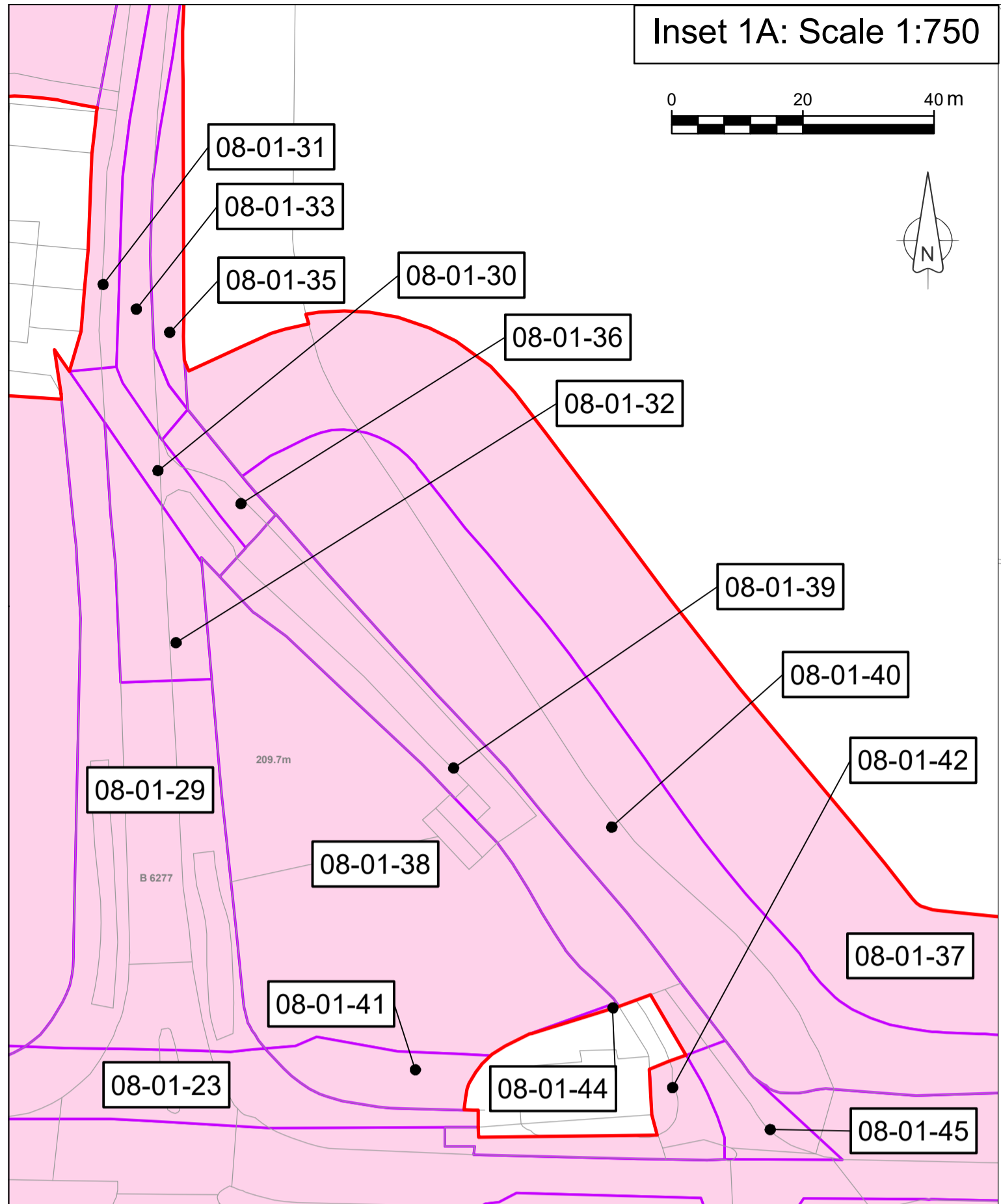

NOTES

1. ALL DIMENSIONS ARE IN METRES UNLESS STATED OTHERWISE.
2. THESE LAND PLANS SHOULD BE READ IN CONJUNCTION WITH OTHER PLANS AND DOCUMENTS IN THE DEVELOPMENT CONSENT ORDER APPLICATION IN PARTICULAR THE BOOK OF REFERENCE.
3. ALL EASEMENTS, SERVITUDES AND PRIVATE RIGHTS IN LAND ARE PROPOSED TO BE EXTINGUISHED ON LAND SHOWN COLOURED PINK ON THESE LAND PLANS. ALL EASEMENTS, SERVITUDES AND PRIVATE RIGHTS IN LAND ARE PROPOSED TO BE EXTINGUISHED, SO FAR AS THEIR CONTINUED EXERCISE WOULD BE INCONSISTENT WITH THE EXERCISE OF THE RIGHTS OR RESTRICTIONS PROPOSED TO BE ACQUIRED BY THE UNDERTAKER ON LAND SHOWN COLOURED BLUE ON THESE LAND PLANS. ALL EASEMENTS, SERVITUDES AND PRIVATE RIGHTS ARE PROPOSED TO BE SUSPENDED WHILE THE UNDERTAKER IS IN TEMPORARY POSSESSION OF THE LAND SHOWN COLOURED GREEN ON THESE LAND PLANS.
4. THE NUMBER LABELS RELATE TO PLOT NUMBERS. PLEASE REFER TO THE BOOK OF REFERENCE FOR MORE INFORMATION ABOUT THESE PLOTS, INCLUDING THE APPROXIMATE AREA OF EACH PLOT (IN SQUARE METRES). PLOT NUMBERS INCLUDE A REFERENCE TO THE RELEVANT SHEET OF THE LAND PLANS. IN THIS NUMBERING CONVENTION, A PLOT NUMBER COMPRISES THE SCHEME NUMBER, FOLLOWED BY THE SHEET NUMBER (OF THE SET OF LAND PLANS RELATING TO THAT NUMBERED SCHEME), FOLLOWED BY THE ACTUAL PLOT NUMBER ON THAT SHEET, E.G. PLOT 03-01-24, WHERE 03 IS THE SCHEME NUMBER (SCHEME 03), 01 IS THE SHEET NUMBER (SHEET 01 OF THE LAND PLANS FOR SCHEME 03) AND 24 IS THE PLOT NUMBER (PLOT 24 ON SHEET 01).

KEY

- ORDER LIMITS
- PERMANENT ACQUISITION OF LAND
- PERMANENT ACQUISITION OF RIGHTS
- TEMPORARY POSSESSION OF LAND
- PERMANENT ACQUISITION OF LAND - REPLACEMENT LAND

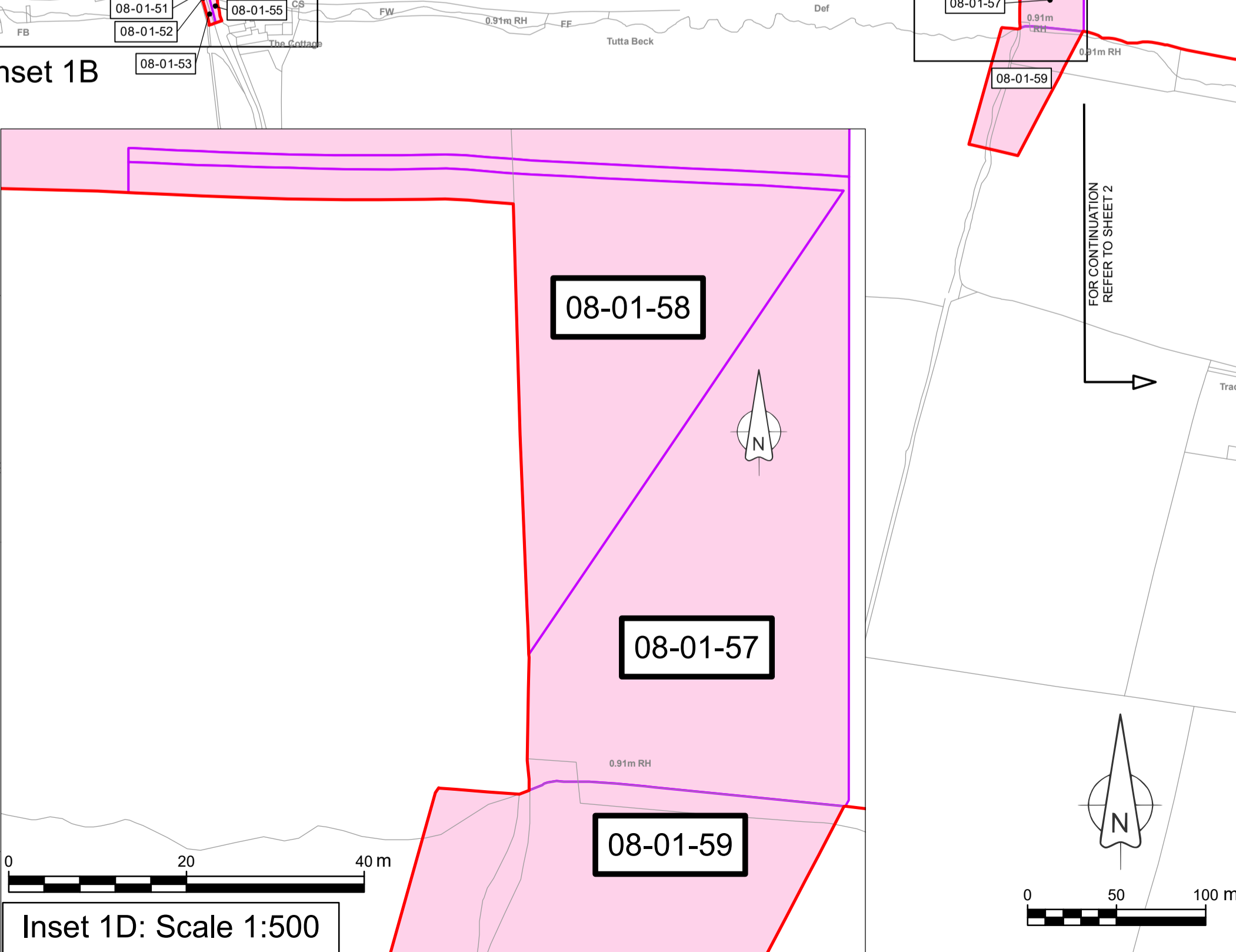
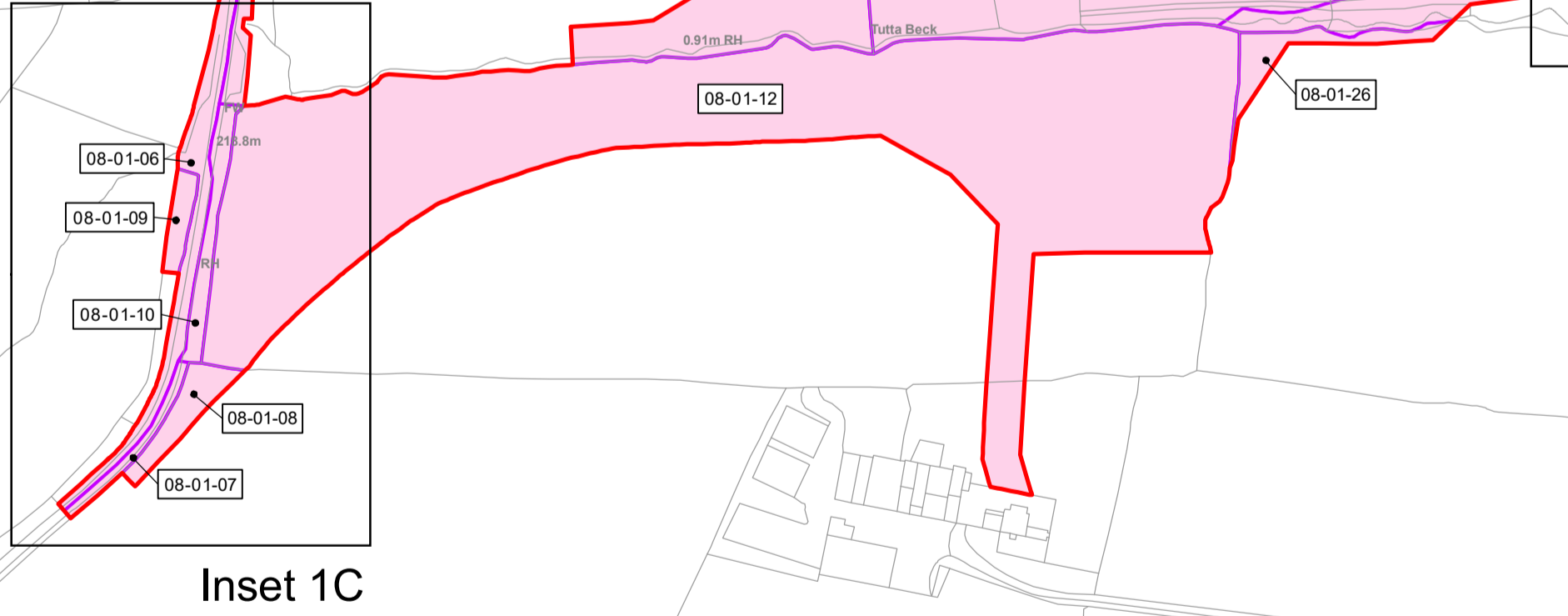
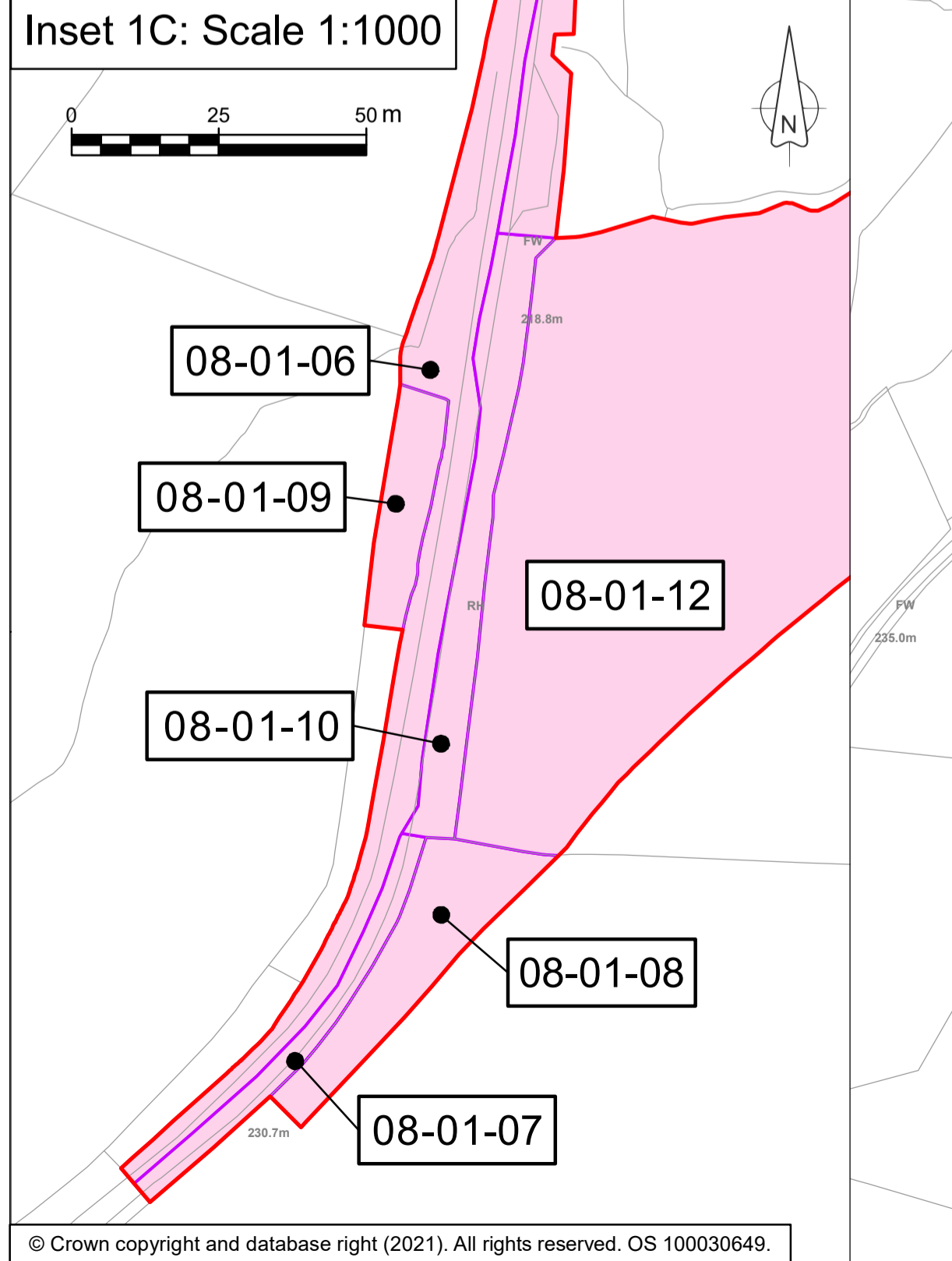
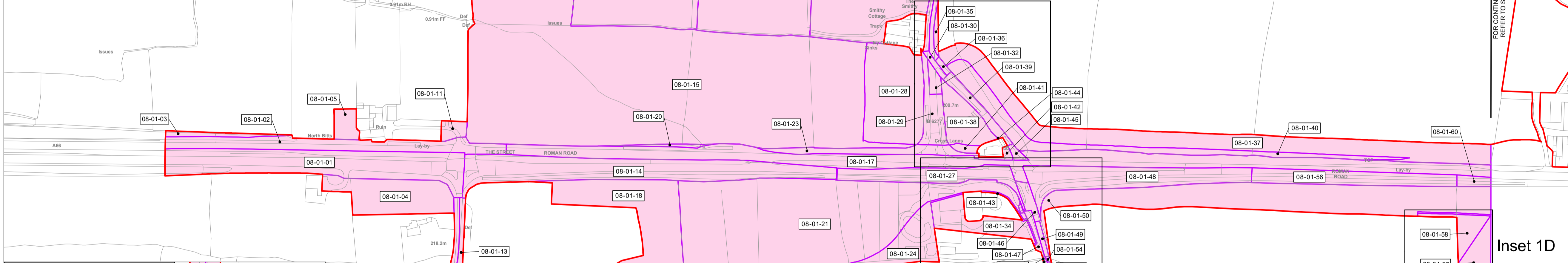
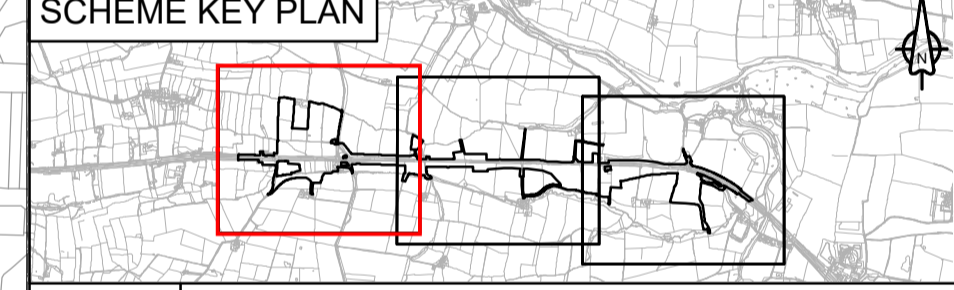

| | | | | | |
|------------------|----------|----------|----------|----------|------------|
| C01 | JHILL | JHILL | NWHIT | GEAC | PCAR |
| | 06/06/22 | 06/06/22 | 07/06/22 | 07/06/22 | 08/06/22 |
| Revision details | | | | | |
| Revision | Created | Checked | Reviewed | Approved | Authorised |
| | dd/mm/yy | dd/mm/yy | dd/mm/yy | dd/mm/yy | dd/mm/yy |

Purpose
DCO APPLICATION

PINS Reference Number
TR010062/APP/5.13

Client
3 Piccadilly Place
Manchester
M1 3BN

Project Name / Scheme Name
A66 Northern Trans-Pennine Project
Scheme 08
Cross Lanes to Rokeby

Drawing Title
Land Plans
Regulation 5(2)(i)
Sheet 1 of 3

| | | | |
|------------------|-------|--------|------|
| Project Ref. No. | Stage | Scale | @ A1 |
| --- | PCF3 | 1:2500 | M |

| | | | |
|------------------------|---------|------------|--------|
| Drawing Number | Project | Originator | Volume |
| HE565627 - AMY - HAC - | S08 | -DR - YL - | 000002 |
| Location | Type | Role | Number |
| | | | |

| | | |
|-------------|-----------------------------|----------|
| Suitability | Suitability Description | Revision |
| A | Approved for Stage Complete | C01 |

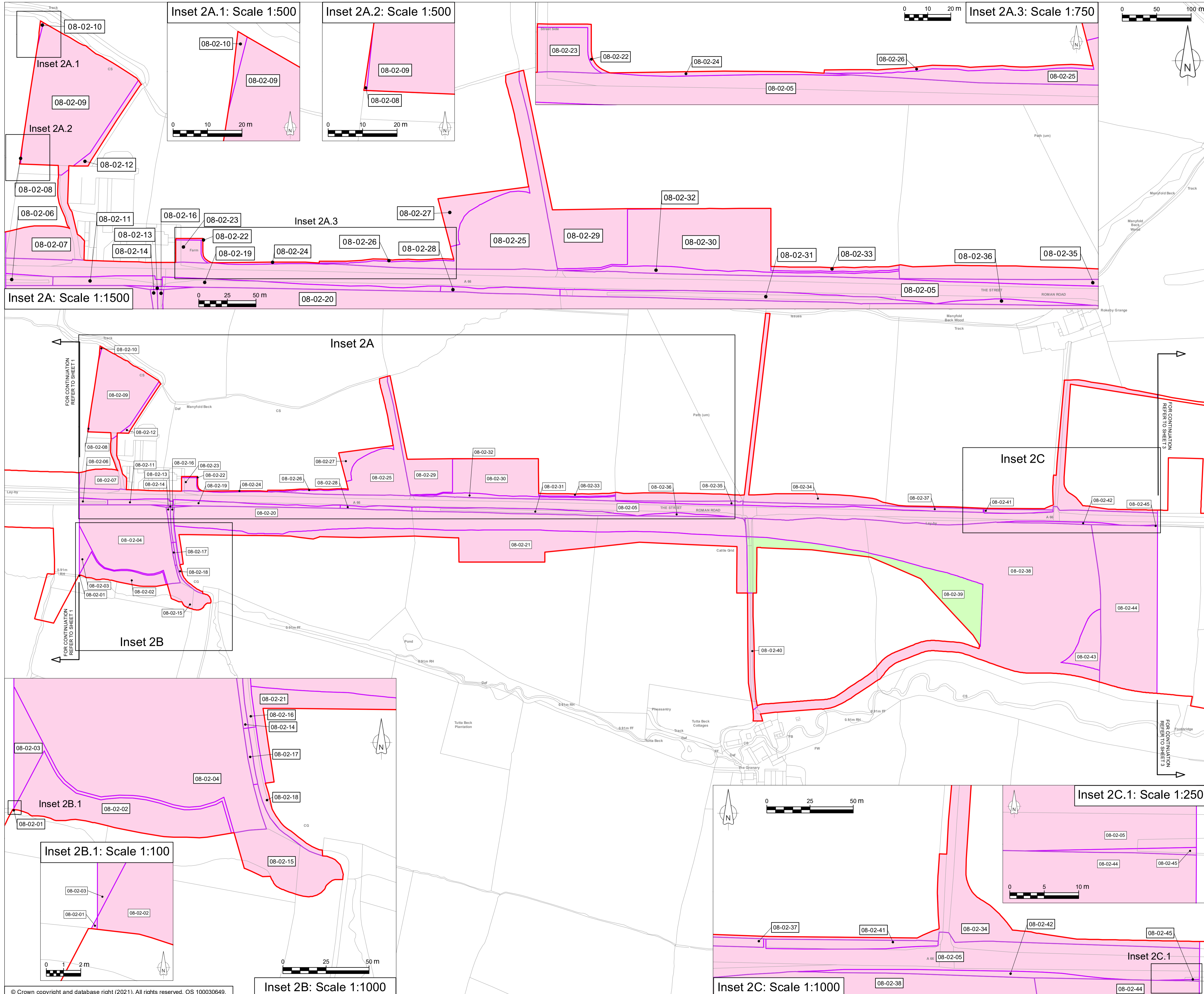

NOTES

1. ALL DIMENSIONS ARE IN METRES UNLESS STATED OTHERWISE.
2. THESE LAND PLANS SHOULD BE READ IN CONJUNCTION WITH OTHER PLANS AND DOCUMENTS IN THE DEVELOPMENT CONSENT ORDER APPLICATION IN PARTICULAR THE BOOK OF REFERENCE.
3. ALL EASEMENTS, SERVITUDES AND PRIVATE RIGHTS IN LAND ARE PROPOSED TO BE EXTINGUISHED ON LAND SHOWN COLOURED PINK ON THESE LAND PLANS. ALL EASEMENTS, SERVITUDES AND PRIVATE RIGHTS IN LAND ARE PROPOSED TO BE EXTINGUISHED, SO FAR AS THEIR CONTINUED EXERCISE WOULD BE INCONSISTENT WITH THE EXERCISE OF THE RIGHTS OR RESTRICTIONS PROPOSED TO BE ACQUIRED BY THE UNDERTAKER ON LAND SHOWN COLOURED BLUE ON THESE LAND PLANS. ALL EASEMENTS, SERVITUDES AND PRIVATE RIGHTS ARE PROPOSED TO BE SUSPENDED WHILE THE UNDERTAKER IS IN TEMPORARY POSSESSION OF THE LAND SHOWN COLOURED GREEN ON THESE LAND PLANS.
4. THE NUMBER LABELS RELATE TO PLOT NUMBERS. PLEASE REFER TO THE BOOK OF REFERENCE FOR MORE INFORMATION ABOUT THESE PLOTS, INCLUDING THE APPROXIMATE AREA OF EACH PLOT (IN SQUARE METRES). PLOT NUMBERS INCLUDE A REFERENCE TO THE RELEVANT SHEET OF THE LAND PLANS. IN THIS NUMBERING CONVENTION, A PLOT NUMBER COMPRISES THE SCHEME NUMBER, FOLLOWED BY THE SHEET NUMBER (OF THE SET OF LAND PLANS RELATING TO THAT NUMBERED SCHEME), FOLLOWED BY THE ACTUAL PLOT NUMBER ON THAT SHEET, E.G. PLOT 03-01-24, WHERE 03 IS THE SCHEME NUMBER (SCHEME 03), 01 IS THE SHEET NUMBER (SHEET 01 OF THE LAND PLANS FOR SCHEME 03) AND 24 IS THE PLOT NUMBER (PLOT 24 ON SHEET 01).

KEY

- ORDER LIMITS
- PERMANENT ACQUISITION OF LAND
- PERMANENT ACQUISITION OF RIGHTS
- TEMPORARY POSSESSION OF LAND
- PERMANENT ACQUISITION OF LAND - REPLACEMENT LAND

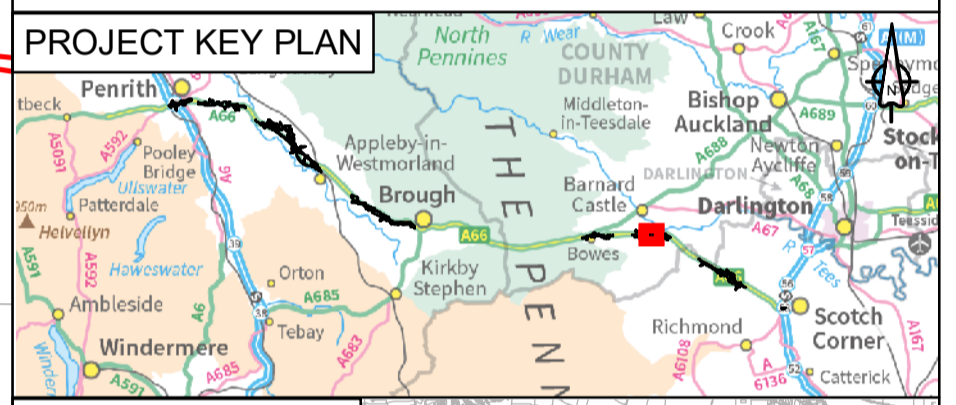

| | | | | | |
|----------|----------|----------|----------|----------|------------|
| C01 | JHILL | JHILL | NWHIT | GEAC | PCAR |
| | 06/06/22 | 06/06/22 | 07/06/22 | 07/06/22 | 08/06/22 |
| Revision | Created | Checked | Reviewed | Approved | Authorised |
| | dd/mm/yy | dd/mm/yy | dd/mm/yy | dd/mm/yy | dd/mm/yy |

Purpose
DCO APPLICATION

PINS Reference Number
TR010062/APP/5.13

Client
**3 Piccadilly Place
Manchester
M1 3BN**

Project Name / Scheme Name
**A66 Northern Trans-Pennine Project
Scheme 08
Cross Lanes to Rokeby**

Drawing Title
**Land Plans
Regulation 5(2)(i)
Sheet 2 of 3**

| | | | |
|------------------|-------|-----------|----|
| Project Ref. No. | Stage | Scale | @ |
| --- | PCF3 | 1:2500 | A1 |
| | | Dimension | M |

Drawing Number
Project | Originator | Volume |
HE565627 - AMY - HAC -
S08 -DR- YL - 000003
Location | Role |
| |

| | | |
|-------------|-----------------------------|----------|
| Suitability | Suitability Description | Revision |
| A | Approved for Stage Complete | C01 |

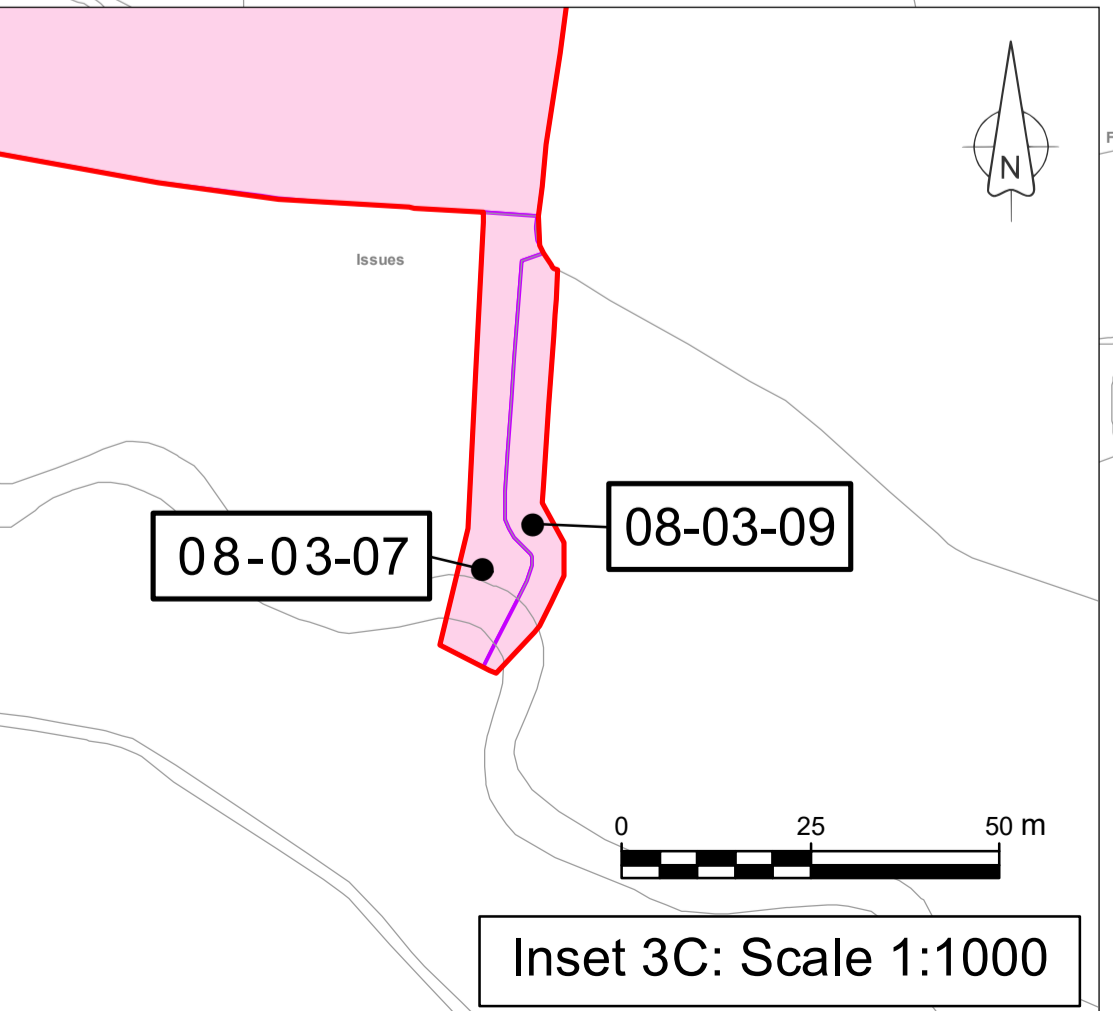
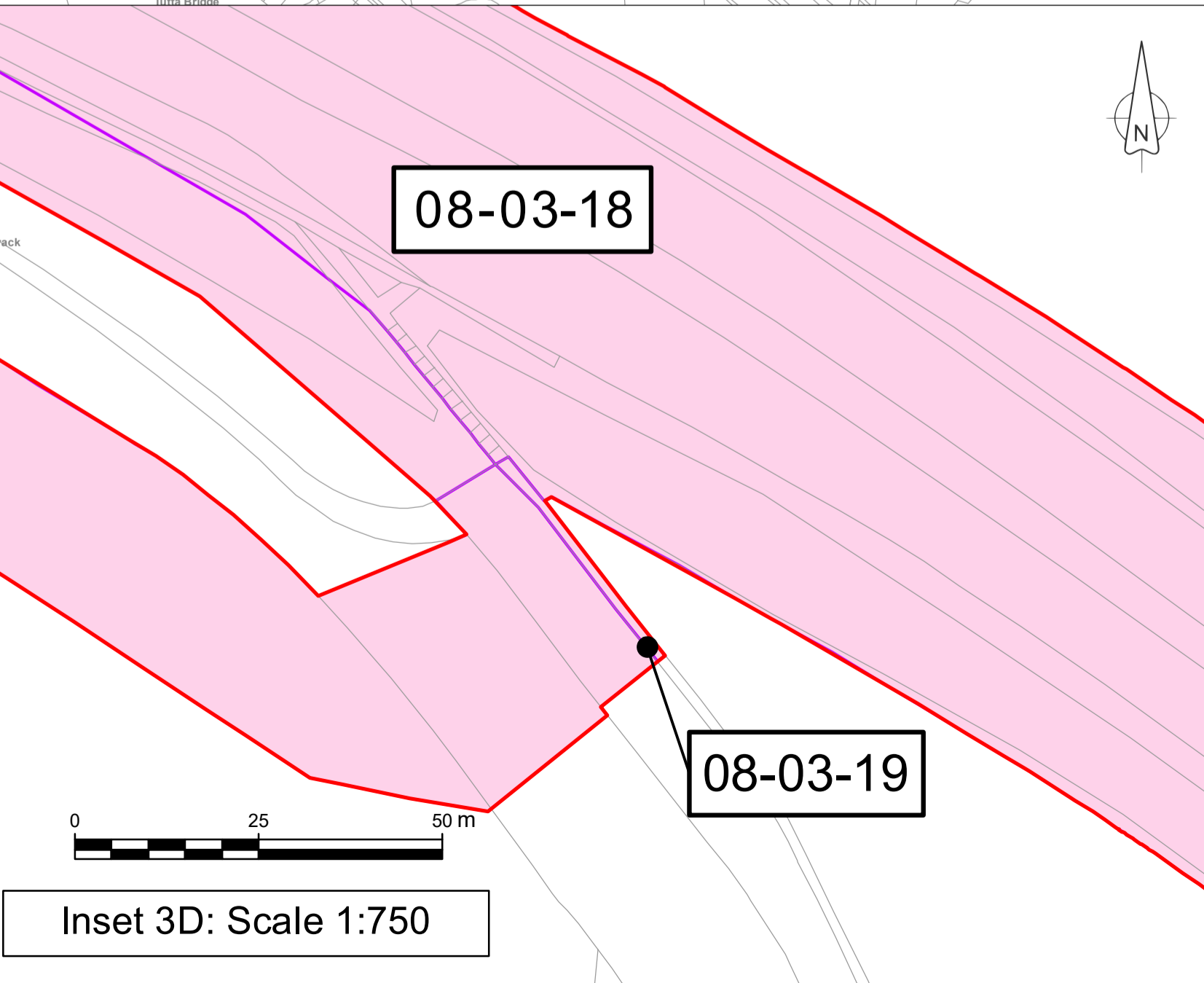
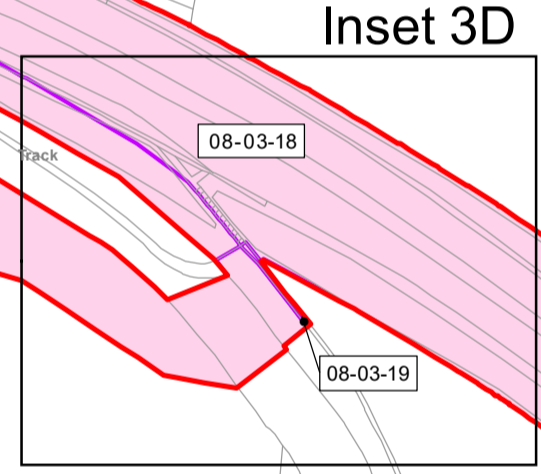
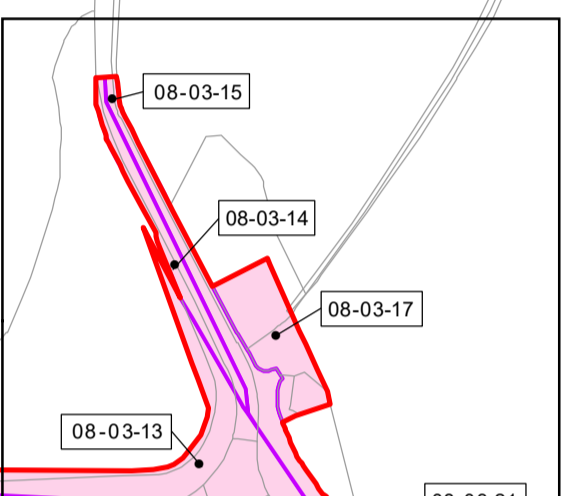
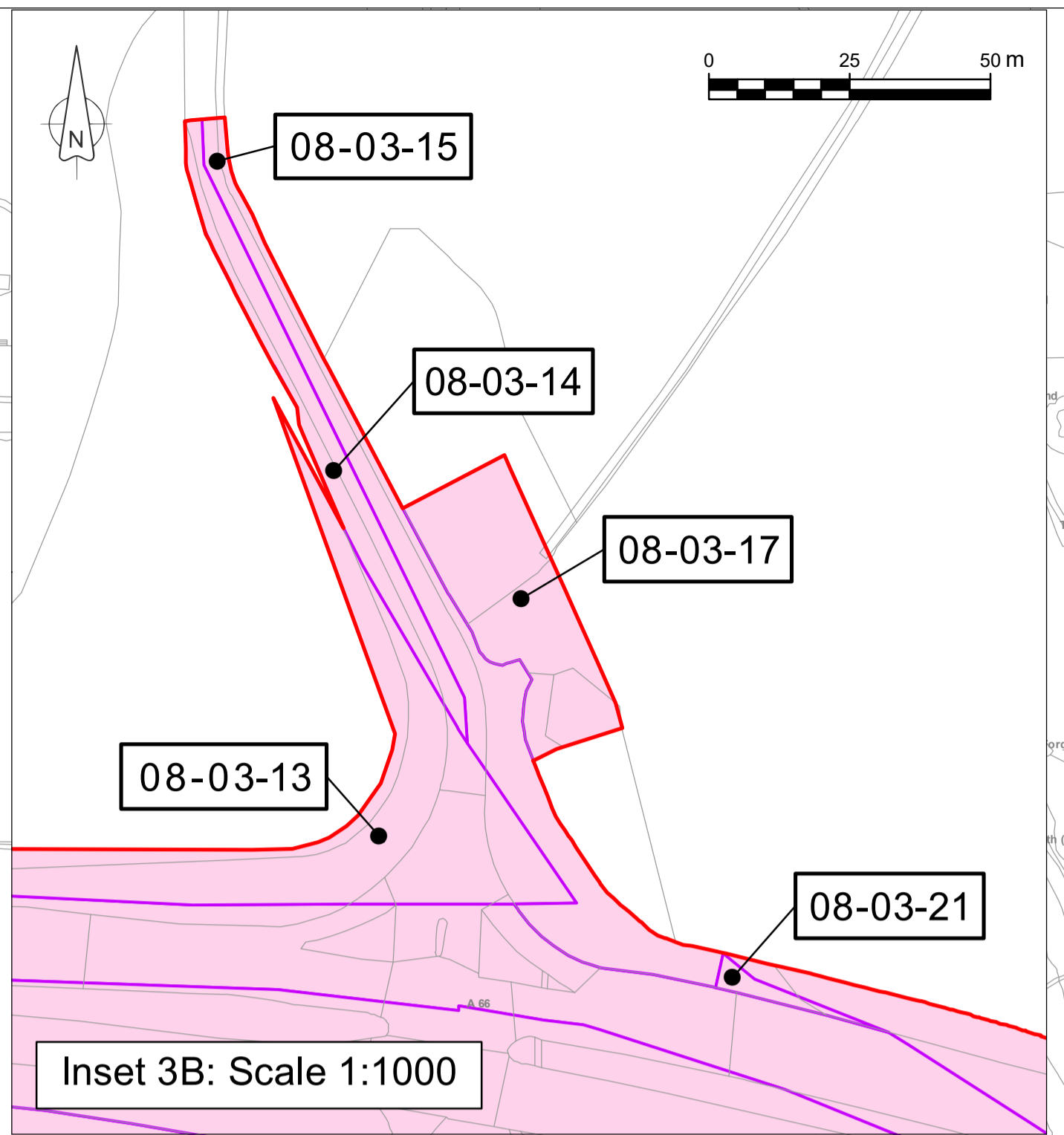
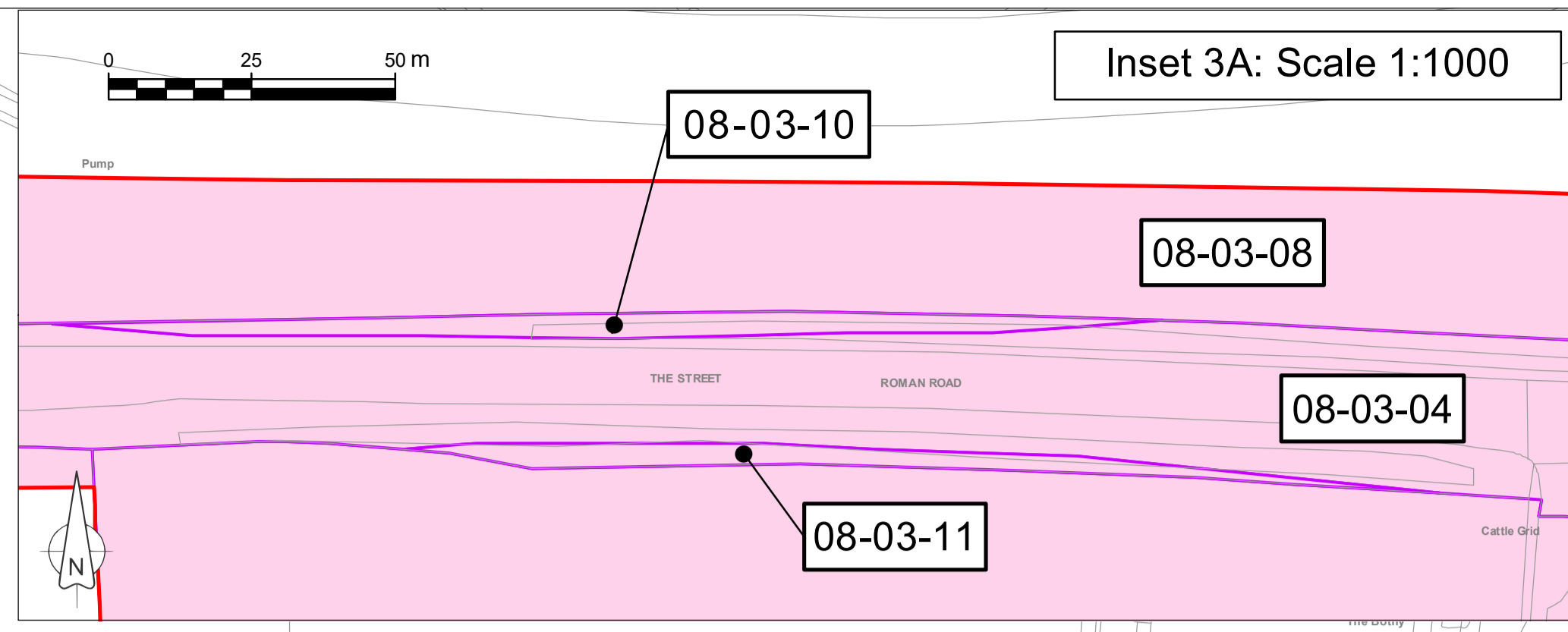
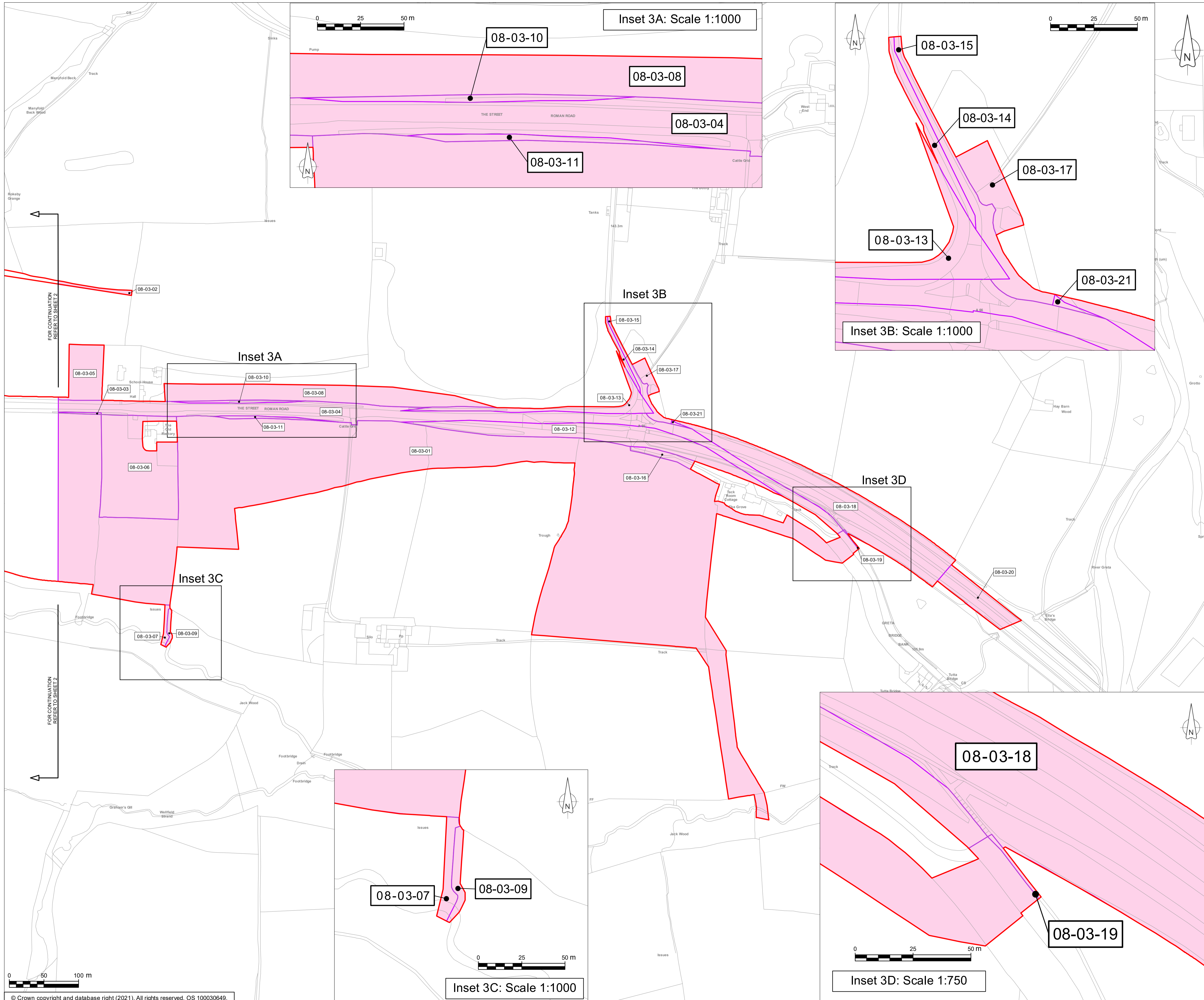

NOTES

1. ALL DIMENSIONS ARE IN METRES UNLESS STATED OTHERWISE.
2. THESE LAND PLANS SHOULD BE READ IN CONJUNCTION WITH OTHER PLANS AND DOCUMENTS IN THE DEVELOPMENT CONSENT ORDER APPLICATION IN PARTICULAR THE BOOK OF REFERENCE.
3. ALL EASEMENTS, SERVITUDES AND PRIVATE RIGHTS IN LAND ARE PROPOSED TO BE EXTINGUISHED ON LAND SHOWN COLOURED PINK ON THESE LAND PLANS. ALL EASEMENTS, SERVITUDES AND PRIVATE RIGHTS IN LAND ARE PROPOSED TO BE EXTINGUISHED, SO FAR AS THEIR CONTINUED EXERCISE WOULD BE INCONSISTENT WITH THE EXERCISE OF THE RIGHTS OR RESTRICTIONS PROPOSED TO BE ACQUIRED BY THE UNDERTAKER ON LAND SHOWN COLOURED BLUE ON THESE LAND PLANS. ALL EASEMENTS, SERVITUDES AND PRIVATE RIGHTS ARE PROPOSED TO BE SUSPENDED WHILE THE UNDERTAKER IS IN TEMPORARY POSSESSION OF THE LAND SHOWN COLOURED GREEN ON THESE LAND PLANS.
4. THE NUMBER LABELS RELATE TO PLOT NUMBERS. PLEASE REFER TO THE BOOK OF REFERENCE FOR MORE INFORMATION ABOUT THESE PLOTS, INCLUDING THE APPROXIMATE AREA OF EACH PLOT (IN SQUARE METRES). PLOT NUMBERS INCLUDE A REFERENCE TO THE RELEVANT SHEET OF THE LAND PLANS. IN THIS NUMBERING CONVENTION, A PLOT NUMBER COMPRISES THE SCHEME NUMBER, FOLLOWED BY THE SHEET NUMBER (OF THE SET OF LAND PLANS RELATING TO THAT NUMBERED SCHEME), FOLLOWED BY THE ACTUAL PLOT NUMBER ON THAT SHEET, E.G. PLOT 03-01-24, WHERE 03 IS THE SCHEME NUMBER (SCHEME 03), 01 IS THE SHEET NUMBER (SHEET 01 OF THE LAND PLANS FOR SCHEME 03) AND 24 IS THE PLOT NUMBER (PLOT 24 ON SHEET 01).

KEY

- ORDER LIMITS
- PERMANENT ACQUISITION OF LAND
- PERMANENT ACQUISITION OF RIGHTS
- TEMPORARY POSSESSION OF LAND
- PERMANENT ACQUISITION OF LAND - REPLACEMENT LAND

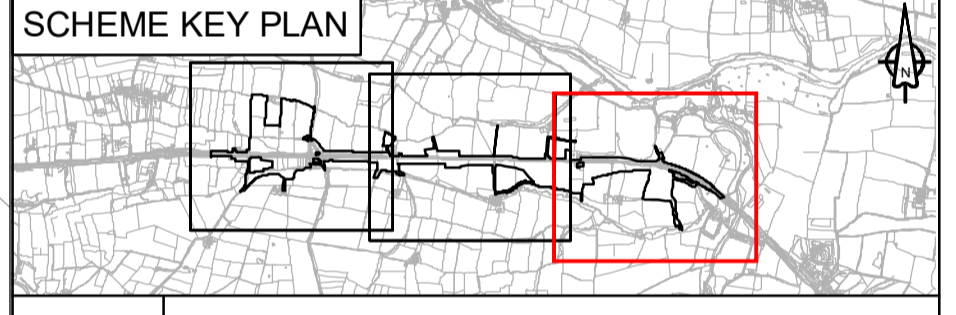
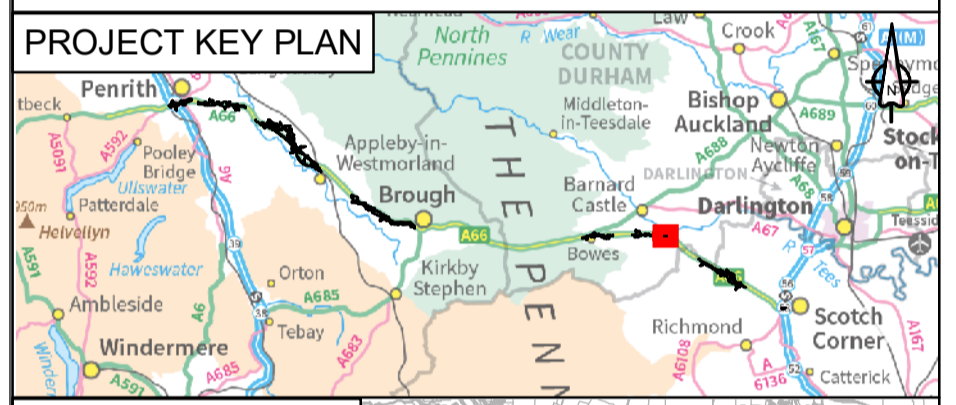

| | | | | | |
|----------|----------|----------|----------|----------|------------|
| C01 | JHILL | JHILL | NWHIT | GEAC | PCAR |
| | 06/06/22 | 06/06/22 | 07/06/22 | 07/06/22 | 08/06/22 |
| Revision | Created | Checked | Reviewed | Approved | Authorised |
| | dd/mm/yy | dd/mm/yy | dd/mm/yy | dd/mm/yy | dd/mm/yy |

Purpose
DCO APPLICATION

PINS Reference Number
TR010062/APP/5.13

Client
3 Piccadilly Place
Manchester
M1 3BN



Project Name / Scheme Name
A66 Northern Trans-Pennine Project
Scheme 08
Cross Lanes to Rokeby

Drawing Title
Land Plans
Regulation 5(2)(i)
Sheet 3 of 3

| | | | | |
|------------------|-------|-------------|--------|------|
| Project Ref. No. | Stage | Scale : | 1:2500 | @ A1 |
| --- | PCF3 | Dimension : | M | |

| | | | | |
|------------------------|------------|------------|--------|--|
| Drawing Number | Project | Originator | Volume | |
| HE565627 - AMY - HAC - | | | | |
| S08 | -DR - YL - | 000004 | | |
| Location | Type | Role | Number | |

| | | |
|-------------|-----------------------------|----------|
| Suitability | Suitability Description | Revision |
| A | Approved for Stage Complete | C01 |